

LET LIFE STAY  
BLOSSOMED.



2 & 3 BHK | LUXURY APARTMENTS | @ BANDLAGUDA



2 BHK  
18 FLATS



3 BHK  
12 FLATS

### GOOD HOME FOR LIFE.

Wishing for good things and also getting blessed with them is a boon few are bestowed with. And those who are blessed with, are the most fortunate bunch of people. S R I Marvel is a home, you could say, designed for those privileged ones. If you have been out in the quest for a home where you can feel blessed for life, this is where your quest will end. Come find your home in which you can discover good things for eternity.





SMALL, BOUNTIFUL AND NICE.

S R I Marvel is an abode that's a blend of one compact and one vast-sized home on every floor of the building. Hosting a 2 BHK apartment of 1230 sft to 3 BHK apartment of 1670 sft, S R I Marvel is a home suitable for both, nuclear family or a joint family. It's designed to give people freedom of space and freedom of privacy, depending on what is priority.



Area Statement

Flat No.	1	2	3	4	5
Type	2 BHK	2 BHK	2 BHK	3 BHK	3 BHK
Facing	East	East	East	West	West
Ground Floor Super Builtup Area in SFT	1255	1230	1255	1670	1550
Typical Floor Super Builtup Area in SFT	1255	1230	1255	1670	1665



PARKING PLAN

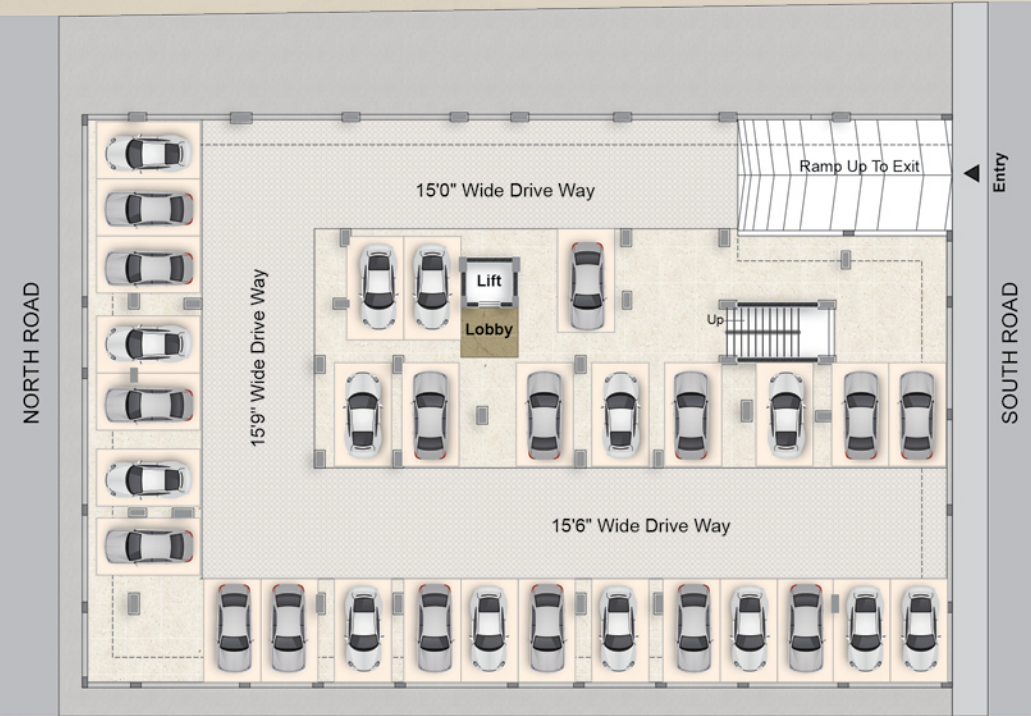

TYPICAL FLOOR PLAN





#### FOUNDATION & STRUCTURE

Structure: RCC framed structure to withstand the wind & seismic load.  
Super Structure: CC brick / Red brick 9" external and 4.5" internal walls.



#### JOINERY WORKS

MAIN DOOR: IT wood frame with two sides veneered flush shutter with melamine polishing and hardware of reputed make.

INTERNAL DOORS: M T wood frame with flush shutter with two sides veneer painted white, fitted with reputed hardware fittings.

TOILET DOORS: M T wood frame and flush shutter with painted white, fitted with reputed hardware.

WINDOWS: 2½ track UPVC window systems with clear glass of reputed make.

FRENCH DOOR: UPVC sliding door shutters with clear glass.

GRILLS: Aesthetically designed bright steel safety grills with enamel paint finish.



#### PLASTERING

INTERNAL WALLS: 18 mm double coat cement plaster with smooth finishing.

CEILING: 12 mm double coat smooth cement plaster finishing.

EXTERNAL WALLS: 18 mm double coat sand faced cement plastering.



#### PAINTING

INTERNAL WALLS & CEILING: Water proof putty finish with two coats of Premium emulsion paint of Asian or equivalent make over a coat of primer.

EXTERNAL WALLS: Texture or Putty finish with 2 coats of exterior emulsion paint of Asian make.

### SPECIFICATIONS



#### FLOORING

LIVING: Vitrified tiles (30"x30") of reputed make.

DINING, BEDROOMS, KITCHEN & BALCONIES: Vitrified tiles (30"x30") of Reputed Make.

BATHROOMS: Anti-skid and acid resistant tiles of standard make.

STAIRCASE / CORRIDOR: Combination of Marble \ Granite \ Vitrified tiles as per architectural design.

UTILITY: Anti-skid tiles of standard make.



#### KITCHEN

Granite platform and stainless steel sink, separate taps for municipal water and borewell water. Provision for fixing of water purifier, exhaust fan.



#### BATHROOMS

All Sanitary fixtures are of Cera \ Jaquar or equivalent make. Single piece EWC in all toilets of Hindware \ Cera \ Jaquar or equivalent make.

All CP fittings are chrome plated of Cera \ Jaquar or equivalent make.



#### DADOING

KITCHEN: Glazed tiles dado up to 2' height above kitchen platform.

BATHROOMS: Glazed tiles of standard make upto door height.



#### ELECTRICAL

- Concealed copper wiring of Polycab make and modular switches of Philips or equivalent make.

- Power outlets for air conditioners in all bedrooms.

- Power outlets for geysers and exhaust fans in all bathrooms.

- Power plug for cooking range chimney, refrigerator, microwave ovens, mixer / grinders in kitchen. Washing machine in utility area.

- Three phase power supply for each unit with individual meter boards.

- Miniature Circuit Breakers (MCB) of reputed make for each distribution board.



#### RAILING

SS Railing for staircases. MS railing for balconies.



#### LIFT

6 Passenger capacity standard make lift of Kone / Johnson or equivalent.



#### WATER SUPPLY

Sump & Overhead tank.



SRI  
**MARVEL**  
MAKE IT FOREVER

### AMENITIES & FEATURES

HUMAN CHESS		GYMNASIUM	
	QUALITY CONSTRUCTION		SEATING AREA
POWER BACK-UP GENERATOR		EXCELLENT VENTILATION	
	KID'S PLAY AREA		SOLAR FENCING
100% VAASTU		RAIN WATER HARVESTING PITS	
	BANQUET HALL		CC TV CAMERA SECURITY

### MADE TO OUTLAST EXPECTATIONS.

S R I Marvel has been made with the most premium of materials to bestow it the look and the longevity.



## LOCATION MAP



CONNECTED  
TO LIFE'S  
COMFORTS.



Office Address:

Plot No. 53, 54 & 55, Ramoji Layout,  
Near The Future Kid's School, Puppalguda Village,  
Gandipet Mandal, R.R District-500089

Cell : 837 449 4444, 837 441 4444

Email : sales@sriinfra.co

Website : www.sriinfra.co



SCAN FOR  
WEBSITE



# First floor, Plot No-258,  
Prashashan Nagar, Road No-78,  
Jubilee hills, Hyderabad - 500033  
Office : 040 - 2331 0971  
Mobile : 7032705459 / 09966640971  
Web : www.instonearchitects.com

NOTE : This brochure is only a conceptual presentation of the project and not a legal offering. The promoters reserve the right to make changes in the elevation, plans and specifications as deemed fit.